

Carol TS



Treuil manuel à vis sans fin Worm gear winch

250 kg - 500 kg - 1000 kg - 1500 kg - 2000 kg - 3000 kg

Notice d'emploi et d'entretien Operating and maintenance instructions

1. Introduction	3
2. Mise en service / Installation	4
2.1. Recommandations / Important operating advice	4
2.2. Mise en place, fixation du treuil / Mounting the winch	4
3. Câble / Wire rope	5
3.1. Sens d'enroulement du câble / Wire rope reeling	5
4. Débrayage / Wire rope release	6
5. Manivelle / Operating handle	6
6. Graissage des engrenages / Lubrication of the gears	6
7. Vues éclatées / Exploded views and spare parts	
7.1. Vue éclatée Carol TS 250 kg - 500 kg - 1000 kg Spare parts view Carol TS 250 kg - 500 kg - 1000 kg	7
7.2. Vue éclatée Carol TS 1000 kg 2V- 1500 kg - 2000 kg Spare parts view Carol TS 1000 kg 2V - 1500 kg - 2000 kg	8
7.3. Vue éclatée Carol TS 3000 kg Spare parts view Carol TS 3000 kg	9
Autres treuils et matériels TRACTEL Other winches and TRACTEL equipment	10
Les Sociétés du Groupe TRACTEL TRACTEL Group Companies	11

1. Introduction

Les treuils à tambour CAROL TS sont compacts, maniables et sûrs .

Ils ont été conçus pour une grande variété d'utilisations

- Double sécurité de la vis sans fin et du frein automatique,
- Tenue dans le temps,
- Facilité d'emploi.

La résistance du treuil est prévue pour lever la charge indiquée sur l'appareil (capacité nominale).

CAROL TS drum winches are compact, easy to handle and safe. They have been designed for a wide variety of applications and have :

- High reliability of worm-gear drives and automatic brake
- Durability
- Facility of use.

CAROL TS drum winches have been designed for lifting loads up to the nominal lifting capacity, indicated on the machine itself.

2. Mise en service / Installation

2.1. Recommendations / Important operating advice

USAGES INCORRECTS / Incorrect usage

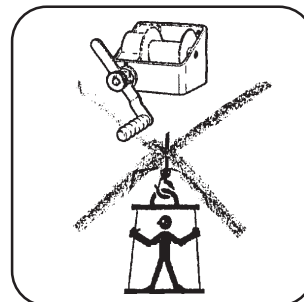
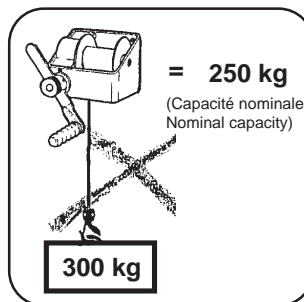
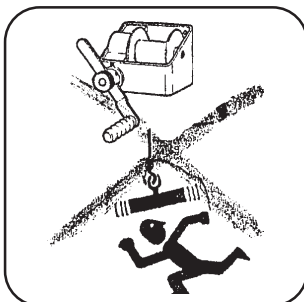
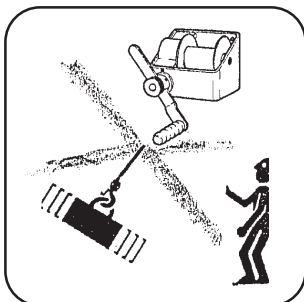

2.2. Mise en place, fixation du treuil CAROL TS / Winch mounting

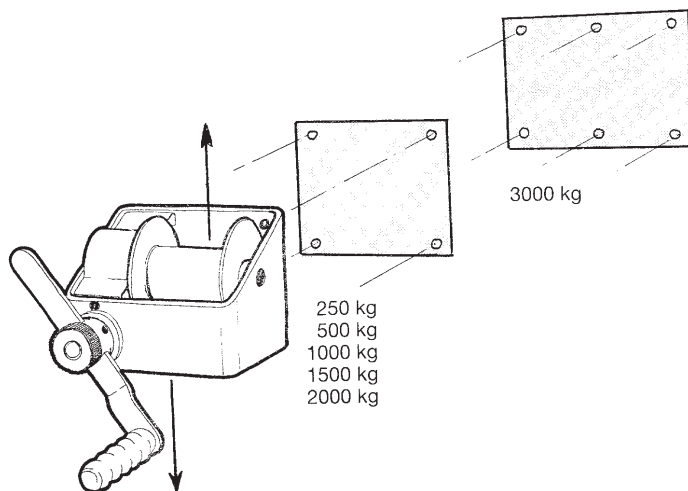

TS 250 =	250 kg	Vis/Screw : x 4 ø 11 mm
TS 500 =	500 kg	Vis/Screw : x 4 ø 13 mm
TS 1000 =	1000 kg	Vis/Screw : x 4 ø 17 mm
TS 1500 =	1500 kg	Vis/Screw : x 4 ø 17 mm
TS 2000 =	2000 kg	Vis/Screw : x 4 ø 21 mm
TS 3000 =	3000 kg	Vis/Screw : x 6 ø 25 mm

3. CABLE / Wire rope

Modèle/Model	ø mm	Capacité maxi. Max. capacity	Nombre de couches Nb of w. rope layers
TS 250	5	20	4
TS 500	6,8	25	4
TS 1000	9	35	4
TS 1500	11,5	20	3
TS 2000	13	30	3
TS 3000	15	40	3

3.1. Sens d'enroulement du câble / Wire rope reeling

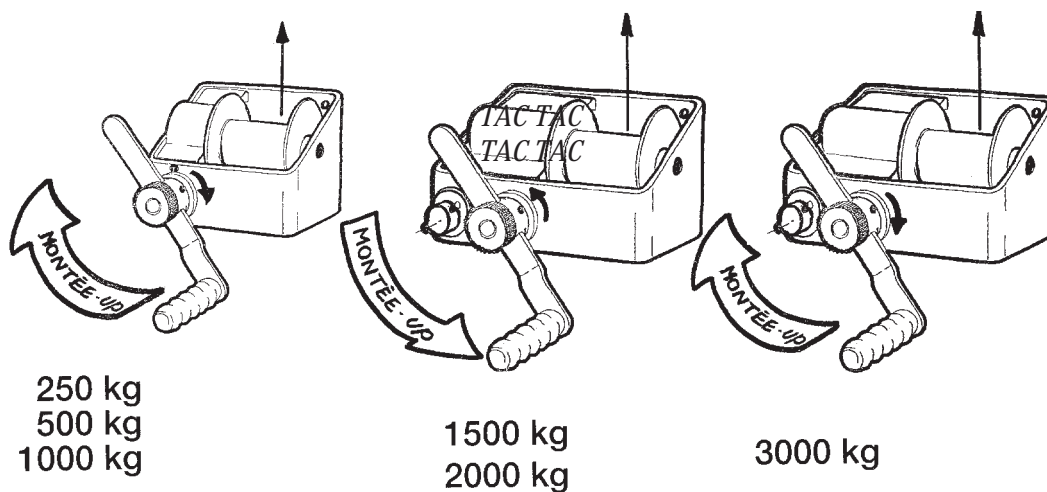

Un attache-câble permet de retenir l'extrémité du câble sur le tambour.
A wire rope clamp allows the end of the wire rope to be secured to the drum.
Tendre le câble et l'enrouler à spires jointes sur le tambour.
With the wire rope slightly tensioned, reel it tightly onto the drum.

4. Débrayage / Releasing the wire rope

Débrayage : dévidage du câble à vide.
NE JAMAIS DEBRAYER EN CHARGE.

Before operating the release mechanism, ensure that there is no load on the wire rope.
NEVER ATTEMPT TO RELEASE THE WINCH WHEN UNDER LOAD.

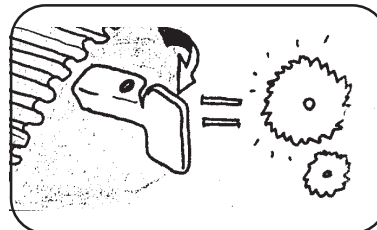
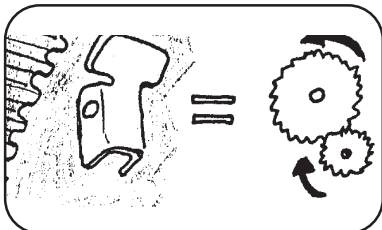
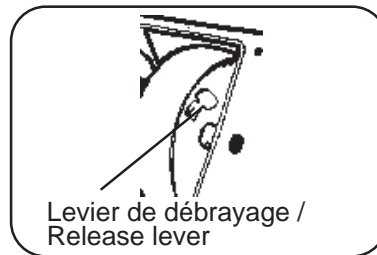

5. Manivelle / Operating handle :

Longueur de manivelle réglable, pour disposer, soit d'une force maxi, soit d'un enroulement rapide.

The length of the operating handle is adjustable for maximum mechanical advantage or for fast reeling of the wire rope.

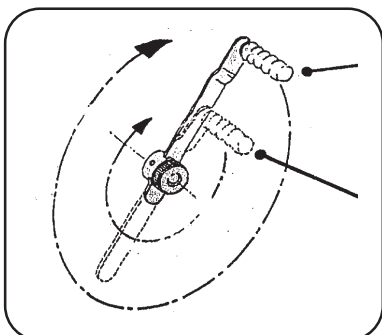

Force maximum
Maximum power

Enroulement rapide
Fast reeling

6. Graissage des engrenages / Lubrication of the gears :

Pour le graissage périodique des pièces, utiliser une graisse de type EP2.

Periodically, lubricate the components : use a grease type EP2.

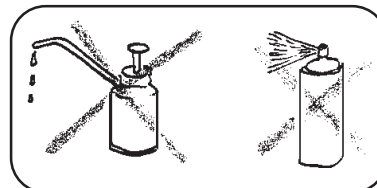
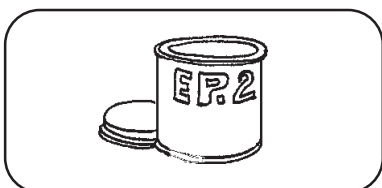

Carol TS 250 - 500 - 1000 kg

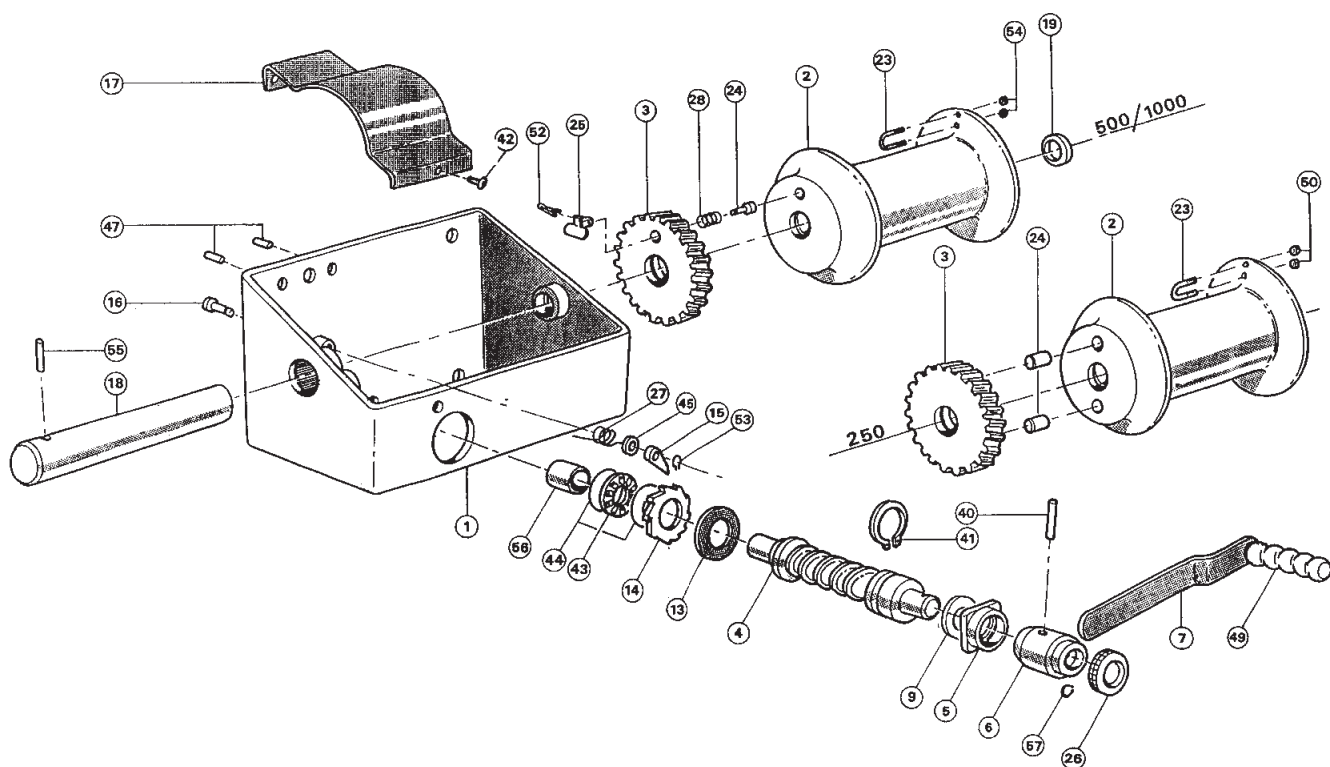

Pos.	TS 250	TS 500	TS 1000	Désignation / Description		Pos.	TS 250	TS 500	TS 1000	Désignation / Description	
1	1253001	1253101	1253201	Châssis	Frame	28	-	1252228	1252228	Ressort	Release spring
2	1253002	1253102	1252202	Tambour	Drum	40	043445301	043445301	043445301	Goupille E8x50	Pin E8x50
3	1253003	1253103	1253203	Roue	Wheel	41	0433541	0433541	0433541	Circlips E47	Snap ring
4	1253004	1253104	1253204	Vis sans fin	Worm gear	42	1252033	1252033	1252033	Vis ULS 6x16	Screw ULS 6x16
5	1253005	1253005	1253205	Palier avant	Front bearing	43	0442100	0442100	1253243	Butée à aiguilles	Stop
6	1252006	1252006	1252006	Tête manivelle	Crank head	44	1253044	1253044	1253244	Rondelle butée	Washer
7	1252107	1252107	1252007	Manivelle	Operating lever	45	0433036	0433036	0433036	Rondelle LU8	Washer LU8
9	1253009	1253009	1253009	Cale	Packing	47	0434534	0434534	0434641	Goupille	Pin
13	1253013	1253013	1253013	Rondelle frein	Brake washer	49	1252037	1252037	1252037	Poignée	Handle
14	1253014	1253014	1253014	Rochet	Ratchet	52	-	0434303	0434303	Goupille V3,2x22	Split pin V3,2x22
15	1252015	1252015	1252015	Cliquet	Catch	53	0433504	0433504	0433504	Circlips E8	Snap ring E8
16	1252016	1252016	1252016	Axe	Spindle	54	043200101	043200101	043200401	Ecrou Hm M4	Nut Hm M4
17	1253017	1253117	1253217	Capot	Cover	55	043443301	043443301	0434469	Goupille	Pin
18	1252118	1253118	1252218	Arbre	Shaft	56	1252237	1252237	1252239	Bague BP25	Sleeve BP25
19	1252119	1252119	1252219	Cale	Packing	57	0433807	0433807	0433807	Circlips	Snap ring
23	0437524	0437524	0437521	Serre-câble	W. rope clamp						
24	1253024	1253124	1253124	Pion	Release pin						
25	-	1252025	1252025	Levier	Release lever						
26	1252026	1252026	1252026	Bouton	Adjust.lever knob						
27	1253027	1253027	1253027	Ressort	Catch spring						

Carol TS 1000 V2 -1500 -2000 kg

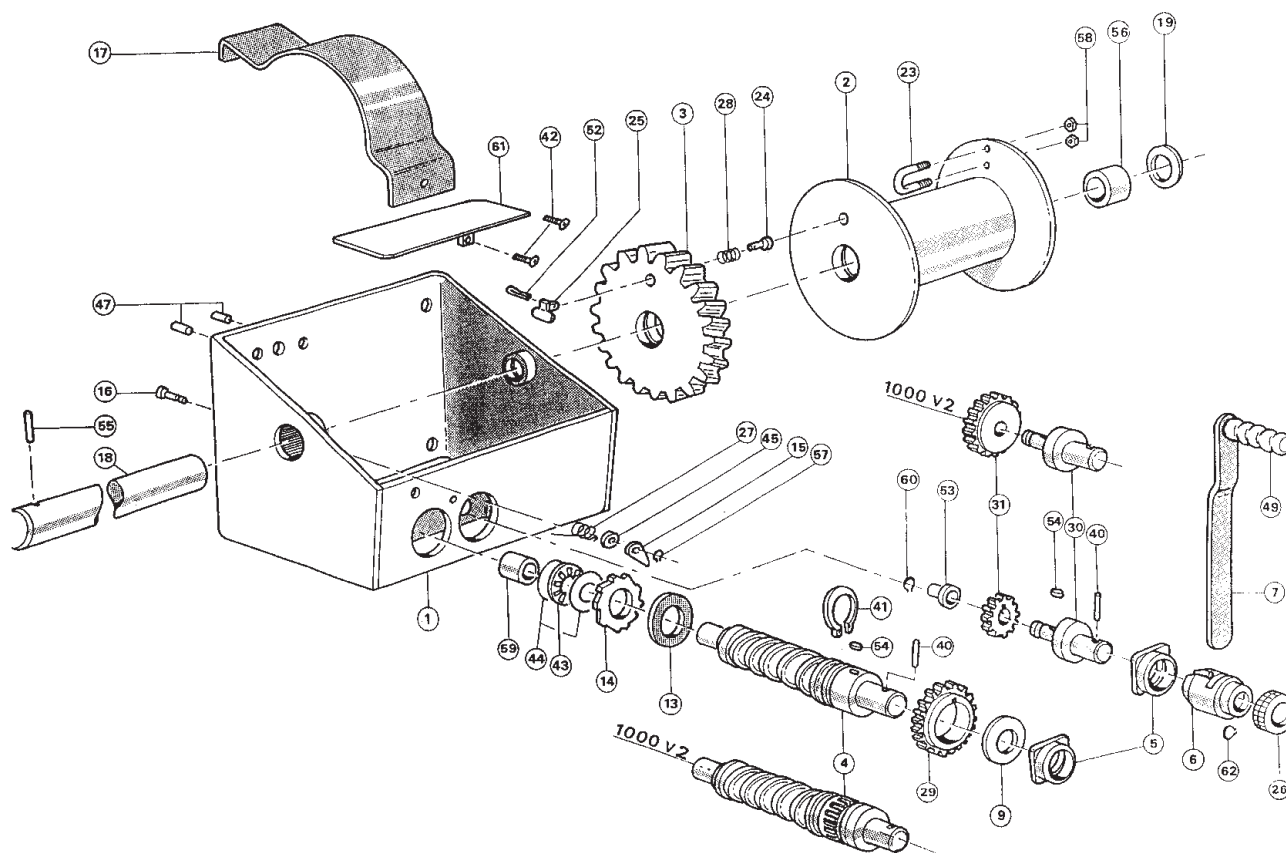

Pos.	TS 1500	TS 2000	Désignation / Description		Pos.	TS 1500	TS 2000	Désignation / Description	
1	1253301	1253401	Châssis	Frame	30	1253330	1253330	Arbre	Shaft
2	1252202	1253402	Tambour	Drum	31	1253331	1253331	Pignon	Gear shaft
3	1253203	1253403	Roue	Wheel	40	043445301	043445301	Goupille E8x50	Pin E8x50
4	1253304	1253404	Vis sans fin	Worm gear	41	0433541	0433541	Circlips E47	Snap ring E47
5	1253205	1253205	Palier avant	Front bearing	42	1252033	1252033	Vis ULS 6x16	Screw ULS 6x16
6	1253306	1253306	Tête manivelle	Crank head	43	1253243	1253243	Butée à aiguilles	Stop
7	1252007	1252007	Manivelle	Operating lever	44	1253244	1253244	Rondelle de butée	Washer
9	1253009	1253009	Cale	Packing	45	0433036	0433036	Rondelle LU8	Washer LU8
13	1253013	1253413	Rondelle frein	Brake washer	47	0434641	0434641	Goupille G6x16	Pin G6x16
14	1253014	1253014	Rochet	Ratchet	49	1252037	1252037	Poignée	Handle
15	1252015	1252015	Cliquet	Catch	52	0434303	0434303	Goupille V3,2x22	Pin V3,2x22
16	1252016	1252016	Axe	Spindle	53	1253353	1253353	Bague BP 25	Sleeve BP 25
17	1253317	1253417	Capot	Cover	54	0434097	0434097	Clavette	Pin
18	1252218	1253418	Arbre	Shaft	55	0434469	0434444	Goupille	Pin
19	1252219	1252319	Cale	Packing	56	-	1252339	Bague BP 25	Sleeve BP 25
23	0437521	0437549	Serre-câble	W. rope clamp	57	0433504	0433504	Circlips E8	Snap ring E8
24	1253124	1253124	Pion	Release pin	58	043200401	0432269	Ecrou	Nut
25	1252025	1252025	Levier	Release lever	59	1252239	1252239	Bague BP 25	Sleeve BP 25
26	1252026	1252026	Bouton	Adj.lever knob	60	0433516	0433516	Circlips E20	Snap ring E20
27	1253027	1253027	Ressort	Catch spring	61	1253361	1253361	Protecteur	Plate
28	1252228	1252228	Ressort	Release spring	62	0433807	0433807	Circlips	Snap ring
29	1253329	1253329	Roue	Wheel					

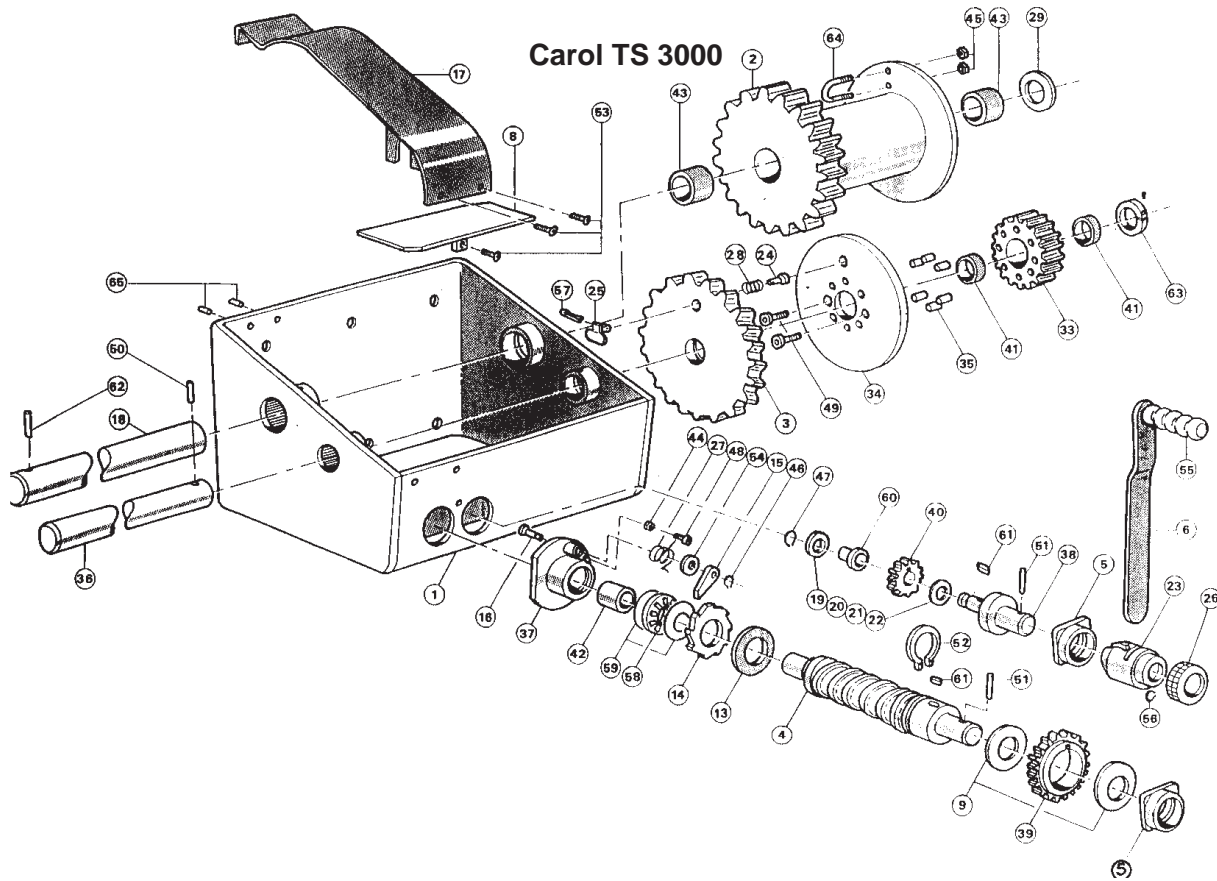

Pos.	Réf.	Code TSA	Désignation / Description		Pos.	Réf.	Code TSA	Désignation / Description	
1	20401	1253501	Châssis	Frame	33	20432	1253533	Pignon	Gear shaft
2	20402	1253502	Tambour	Drum	34	20433	1253534	Flasque débray.	Release plate
3	20403	1253503	Roue	Wheel	35	20434	1253535	Pieu	Pin
4	20404	1253504	Vis sans fin	Worm gear	36	20435	1253536	Arbre	Shaft
5	20105	1253205	Palier avant	Front bearing	37	20436	1253537	Palier arrière	Rear bearing
6	20107	1252007	Manivelle	Operating lever	38	20180	1253330	Arbre	Shaft
8	20108	1253361	Protecteur	Plate	39	2022ç	1253539	Roue	Wheel
9	20109	1253509	Cale	Packing	40	20231	125331	Pignon	Gear shaft
13	20313	1253413	Rondelle frein	Brake washer	41	3033	1253541	Bague BP 25	Sleeve BP 25
14	20014	1253014	Rochet	Ratchet	42	3245	1252239	Bague BP 25	Sleeve BP 25
15	20015	1252015	Cliquet	Catch	43	3511	1253543	Bague BP25	Sleeve
16	20016	1252016	Axe	Spindle	44	13016	043200401	Ecrou Hu8	Nut Hu8
17	20417	1253517	Capot	Cover	45	13018	0432269	Ecrou Hu10	Nut Hu10
18	20418	1253518	Arbre	Shaft	46	13041	0433504	Circlips E8	Snap ring E8
19	20019	1252119	Cale	Packing	47	13045	0433516	Circlips E20	Snap ring E20
23	20156	1253306	Tête manivelle	Crank head	48	13066	043106001	Vis HM8x25	Screw HM8x25
24	20024	1253124	Pion	Release pin	49	13150	0431526	Vis Hc M10x20	Screw
25	20025	1252025	Levier	Release lever	50	13417	0434444	Goupille E10x60	Pin
26	20026	1252026	Bouton	Adj.lever knob	51	20040	043445301	Goupille E8x50	Pin E8x50
27	21027	1252127	Ressort	Catch spring	52	20041	0433541	Circlips E47	Snap ring E47
28	20028	1252228	Ressort	Release spring	53	20042	1252033	Vis ULS 6x16	Screw ULS
29	20419	1253529	Cale	Packing	54	20045	0433036	Rondelle LU8	Washer LU8
					55	20049	1252037	Poignée	Handle
					56	20050	0433807	Circlips	Snap ring
					57	20052	0434303	Goupille V3,2x22	Split pin
					58	20143	1253243	Butée à aiguilles	Stop
					59	20144	1253244	Rondelle de butée	Washer
					60	20168	1253353	Bague BP 25c	Sleeve
					61	20169	1253561	Clavette	Pin
					62	20437	0434451	Goupille E12x80	Pin
					63	20438	1253563	Bague d'arrêt	Stop sleeve
					64	3184	0437522	Serre-câble	W.rope clamp
					65	20147	0434641	Goupille G6x16	Pin

**AUTRES TREUILS A TAMBOUR CAROL :
OTHER CAROL WINCHES :**

Treuil manuel / Manual drum winches :

- Treuil à engrenages CAROL TR
Capacités : 150 kg à 2000 kg
- CAROL TR geared winches
Capacities : 150 kg to 2000 kg

Treuil à tambour motorisés / Powered drum winches :

- Multi-positions de fixation
Capacités : 200 kg - 300 kg - 500 kg - 800 kg
- Multiple anchor positions
Capacities : 200 kg - 300 kg - 500 kg - 800 kg
- Treuil standard CAROL TE
- CAROL TE standard powered drum winches
- Treuil avec châssis CAROL TC (chantiers)
- CAROL TC powered drum winches mounted in frame
(for site operation)

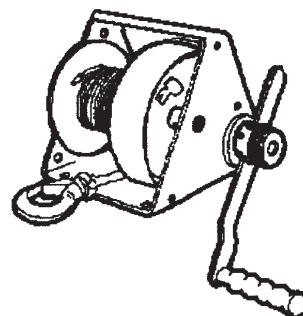

CAROL TR

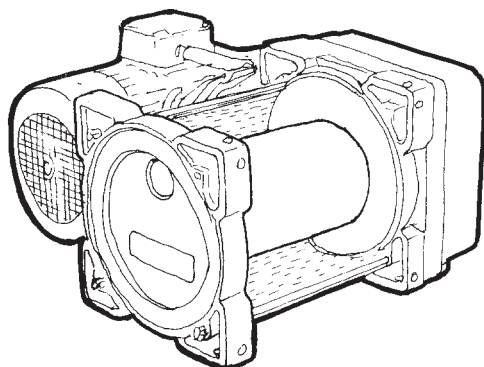

CAROL TE

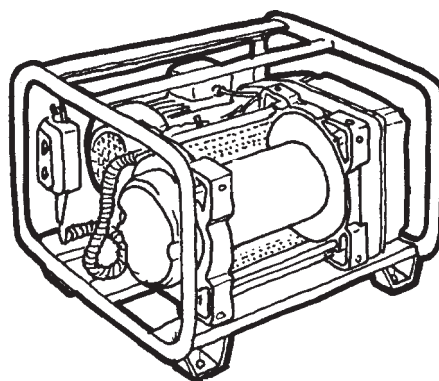

CAROL TC

Les sociétés du Groupe TRACTEL et leurs revendeurs agréés vous fourniront sur demande leur documentation concernant la gamme des autres produits TRACTEL :

- appareils de levage et de traction,
- matériel d'accès de chantier et de façade,
- dispositifs de sécurité,
- indicateurs de charge électroniques,
- accessoires tels que poulies, crochets, élingues, ancrages, etc...

TRACTEL Group Companies and their agents and distributors will be pleased to supply on request illustrated documentation on the complete range of TRACTEL products :

- TIRFOR lifting and pulling machines,
- MINIFOR portable electric hoists,
- TIRAK powered mobile winches, and other lifting and handling equipment,
- access equipment for temporary and permanent work on facades and structures,
- BLOCSTOP safety devices,
- DYNAFOR electronic load indicators and DYNASAFE load monitoring and limiting devices, and,
- accessories, such as pulleys, ground anchors, hooks, slings, etc...